



PROMET VALVES AUSTRALIA

1A Green Road Woodville West SA 5011
 www.prometvalves.com promet@prometvalves.com
 T: 08 8268 1777 ABN 47096 425 697 F: 08 8268 1711

Resilient Seat PN10 Flanged Ball Check Valve (Table D)



Material List	
PART	MATERIAL
Body	Ductile Iron
Cover	Ductile Iron
Ball	Metal + EPDM
Gasket	EPDM

Specifications	
Cold Working Pressure	1000kPa
MAX Working Temperature	120°C
Flanges	AS2129 T/D
Face to Face	DIN3202

Applications - Water Treatment Plants

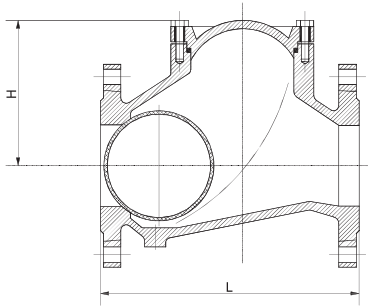

Resilient Seat PN10 Flanged Ball Check Valve (Table D)						
CODE	IMPERIAL SIZE	L	H	HOLE DIAMETER	NO. HOLES	APPROX. KG/PC
VFBC94D	4	300	186	18	4	21.7
VFBC96D	6	400	250	18	8	45.3
VFBCX25D	10	600	443.7	22	8	163